

Racor Doble Anillo Trale LOK

Racor recto hembra

Racor recto hembra rosca NPT

Acero Inoxidable AISI 316-L-1.4404

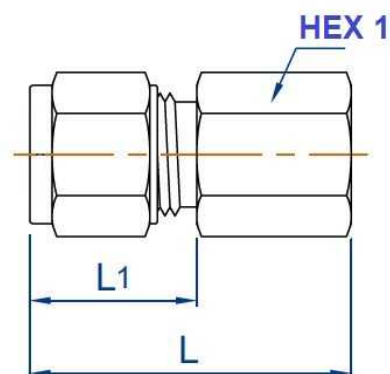

Artículo	ØD1	R1	Ø int	L	L1	HEX 1
ZKIHP0202	1/8"	1/8"	2.28	28,95	15,24	9/16
ZKIHP0204	1/8"	1/4"	2.28	33,53	15,24	3/4
ZKIHP0206	1/8"	3/8"	2.28	37,6	17,68	7/8
ZKIHP0208	1/8"	1/2"	2.28	42,42	17,78	1-1/16
ZKIHP0402	1/4"	1/8"	5.08	31,24	17,78	9/16
ZKIHP0404	1/4"	1/4"	5.08	36,07	17,78	3/4
ZKIHP0406	1/4"	3/8"	5.08	37,59	17,78	7/8
ZKIHP0408	1/4"	1/2"	5.08	42,42	17,78	1-1/16
ZKIHP0602	3/8"	1/8"	7.11	32,77	19,3	5/8
ZKIHP0604	3/8"	1/4"	7.11	37,60	19,3	3/4
ZKIHP0606	3/8"	3/8"	7.11	39,11	19,3	7/8
ZKIHP0608	3/8"	1/2"	7.11	43,94	19,3	1-1/16
ZKIHP0612	3/8"	3/4"	7.11	47	19,3	1-3/8
ZKIHP0802	1/2"	1/8"	10.41	40,38	22,1	5/8
ZKIHP0804	1/2"	1/4"	10.41	40,38	22,1	13/16
ZKIHP0806	1/2"	3/8"	10.41	41,91	22,1	7/8
ZKIHP0808	1/2"	1/2"	10.41	46,74	22,1	1-1/16
ZKIHP1008	5/8"	1/2"	12.7	46,73	22,1	1-1/16
ZKIHP1208	3/4"	1/2"	15.5	46.74	22,1	1-1/16
ZKIHP1212	3/4"	3/4"	15.50	49,79	22,1	1-3/8
ZKIHP1612	1"	3/4"	21.85	54.61	26,67	1-3/8
ZKIHP1616	1"	1"	21.85	62,49	26,67	1-5/8
ZKIHP06M02	6	1/8"	5	31,3	17,7	14
ZKIHP06M04	6	1/4"	5	36,1	17,7	19
ZKIHP06M06	6	3/8"	5	37,70	17,7	22
ZKIHP06M08	6	1/2"	5	42,5	17,7	27
ZKIHP08M02	8	1/8"	6.5	32.1	18,6	15

Racor Doble Anillo Trale LOK

Racor recto hembra

Racor recto hembra rosca NPT

Acero Inoxidable AISI 316-L-1.4404

Artículo	ØD1	R1	Ø int	L	L1	HEX 1
ZKIHP08M04	8	1/4"	6.5	36,9	18,6	19
ZKIHP08M06	8	3/8"	6.5	38,5	18,6	22
ZKIHP08M08	8	1/2"	6.5	38,5	18,6	27
ZKIHP10M04	10	1/4"	7.9	37,80	19,5	19
ZKIHP10M06	10	3/8"	7.9	39,4	19,5	22
ZKIHP10M08	10	1/2"	7.9	44,1	19,5	27
ZKIHP12M04	12	1/4"	9.5	41,9	22	22
ZKIHP12M06	12	3/8"	9.5	41,9	22	22
ZKIHP12M08	12	1/2"	9.5	46,6	22	27
ZKIHP16M08	16	1/2"	12.7	46,9	22	27
ZKIHP20M12	20	3/4"	16	49,7	22	35
ZKIHP22M12	22	3/4"	18	49,7	22	35
ZKIHP25M12	25	3/4"	22	53.6	26,5	35
ZKIHP25M16	25	1"	22	62,3	26,5	41
ZKIHP3232	2"	2"				